

# Freestanding Bathtubs



**MAAX<sup>®</sup>**  
Enjoy the experience

# Enjoy the experience

Always in style, freestanding bathtubs offer a sophisticated aesthetics that never fades with fashion of the day. MAAX wants everyone who encounters our products to “Enjoy the Experience.” We do that by putting everything we have, every consideration, into ensuring you not only enjoy the therapeutic and functional benefits our products provide but also the entire experience, from product selection through installation and beyond.

After more than 40 years in business, we’ve learned that making things easier for all our customers – businesses and individuals alike – is what makes us succeed. That is why MAAX never stops listening to your ideas, needs and desires. We want to create products that make your life better. We promise that by choosing MAAX, you get more than a superior bath product. You get an experience.

An experience we know you will enjoy.



A red freestanding bathtub is the central focus, positioned in front of a large, multi-paned window. The window looks out onto a city street with buildings. To the right of the window, a dark curtain with a light-colored pattern hangs. A light-colored rug with a dark pattern is on the floor to the right. A small blue and white stool is partially visible on the far right. The bathtub has a white interior and a red exterior. The faucet and handles are chrome. The text 'Collection Freestanding Bathtubs' is overlaid on the red part of the tub, and 'Design, Innovation and Lasting Artisanship' is below it.

# Collection Freestanding Bathtubs

Design, Innovation and Lasting Artisanship

# Miles 6636



66" x 36" x 23"

- Classic cool rectangular 2-piece, virtually seamless look
- Two deck widths for different styles of faucet
- 4 self-leveling legs for ease of installation
- Center drain
- Above-the-Floor Rough (AFR)
- Apron available in White and five bold colors



# Optik® 6636 F



66" x 36" x 24"

- Sleek post-minimalist 2-piece combines straight and curvaceous lines • Deep bathing well
- Inclined backrest • Curvaceous inset armrests
- Two deck widths for different styles of faucet
- 4 self-leveling legs • Center drain • Above-the-Floor Rough (AFR)
- Apron available in White and five bold colors



# Optik® 6032 F



60" x 32" x 23"

- Sleek post-minimalist 2-piece combines straight and curvaceous lines • Deep bathing well
- Inclined backrest • Curvaceous inset armrests
- Large deck for mounted faucet
- 4 self-leveling legs • End drain • Above-the-Floor Rough (AFR)
- Apron available in White and five bold colors





## Ella 6636 Sleek



66" x 36" x 24"

- Graceful classic oval bathtub; 2-piece with concealed seam
- Ample deck space for versatile faucet installation
- 4 self-leveling legs for ease of installation
- Center drain • Above-the-Floor Rough (AFR)
- No system available
- Apron available in White and five bold colors



Glacier Blue



Thunder Gray



Pink Martini



Sterling Silver



Black

## Ella 6636 Embossed Design



66" x 36" x 24"

- Graceful classic oval bathtub with elegant embossed design
- 2-piece with concealed seam
- Ample deck space for versatile faucet installation
- 4 self-leveling legs for ease of installation
- Above-the-Floor Rough (AFR)
- Center drain • No system available • Available in White only



## Ambrosia® F



66" x 36" x 24"

- Unique feature: handcrafted one-piece seamless design
- Soft unique egg shape with one larger and one narrower end
- Contoured lip area follows the natural lines of one's neck
- Sleek waste & overflow included
- Center drain
- Available in White only



## Jazz®



66" x 36" x 24"

- Unique feature: air massage system available
- Deep soak bathing for ultimate relaxation
- Relaxing backrest • Deck for faucet
- 4 self-leveling legs for ease of installation
- Center drain
- Available in White, Bone and Biscuit only



## Roman F



70" x 44" x 25"

- Seamless bathtub reminiscent of 19th century enameled fireclay style
- Ingeniously integrated armrests for added stability
- Ample deck space for faucet
- Waste and overflow included • 12-inch grab bar optional
- Center drain • Available in White only



## Souvenir® with apron



72" x 44" x 25"

- Unique feature: available with air and whirlpool massage systems
- White or Biscuit cushion with a chrome-plated support and chrome-plated towel bar included
- Relaxing armrests • Ergonomic backrest • Deck for faucet
- A maple solid wood storage unit hides pump and/or blower
- Center drain



## Urban® F



72" x 42" x 24"

- Concealed filling system
- Cascading waterfall optional in gray slate or white marble
- Detachable deck for easy maintenance
- Magnetic cushion available in Black or White (optional)
- Urban semi or fully plumbed faucet option highly recommended (specify location)
- 1-piece apron • Center drain • In White and Biscuit only



## Versailles®



67" x 31" x 28"

- Traditional clawfoot acrylic tub with Black iron finish feet has old world charm
- Long soaker tub for total immersion and relaxation
- Smooth interior and exterior
- Freestanding faucet available • No massage system available
- Center drain • Available in White only



# RECIPES

For your Body, Mind and Soul

Complement your bath by adding some of your own bath enhancements and make your home spa experience complete.

## Lavender Bath Crystals

- 2 cups Epsom salt
- 4 drops lavender essential oil
- ½ teaspoon vegetable liquid glycerine

Pour Epsom salt into container. Drop lavender oil and glycerine over salt. Mix together. Remove entire contents and place in moisture-proof, sealable container. Let sit for 2 days, then add a handful to your next bath.



*Lavender is nature's cure for a variety of ailments, from aching joints to a frazzled mind. And, the cleansing properties of salt help pull harmful impurities from your body – and your soul.*



## Indulge your senses Invigorate your spirits

Your body deserves a little pampering now and then, and MAAX has just what it takes to help you recover from your long, busy day.



### Water massage

Strategically placed jets pulse and swirl water with masseuse-like precision in the right places to relax and revive your muscles.



### Air massage

Enjoy a rippling massage as gentle, soothing, quiet and pure as a simple spring rain.



### Combined massage

Elevate your experience by combining our exclusive water and air-jet massage systems for the ultimate spa-quality refreshment.

## O<sub>3</sub>

### Ozonator

Clean and purify your whirlpool by harnessing one of Mother Nature's most powerful elements.

## REST

### REST Whirlpool System

How quiet is the Rest system? This revolutionary system is 66% quieter than the average whirlpool pump.



### Silent Solution

Ears enjoy our therapy systems, too, thanks to noise reduction systems that help worries and cares whisper away.



### Chromatherapy

Bathe yourself in a kaleidoscope of color and envelop yourself in optimal health.



### Heat therapy

Lean back and melt into a total relaxation and relief for that achy neck, back and shoulders.

# TOUCH

The final

Personalize any MAAX Collection freestanding bathtubs so it best suits your sense of style and desired bathing experience by choosing from among our selection of quality accessories that must be ordered separately.

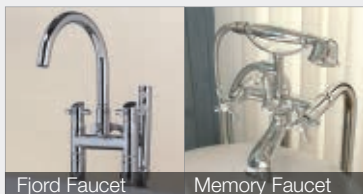

## Fjord et Memory Faucet

Modern or classic style freestanding solid brass faucets. Equipped with handheld shower. Available in chrome and brush nickel finishes.



## Magnetic Cushion | Optik

For a comfortable bathtub experience. Available in black or white.



## Suction Pad Cushion

For a comfortable bathtub experience.



## Waste & Overflow

Cable operated and flexible neck for installation simplicity.



## Trim Kit

Match the color of your bathtub jets and control panel with your bathroom décor. Available in chrome, polished brass or brushed nickel finishes.



# Builder-Ready **Freestanding Bathtubs**

Ease. Please. Style.

# BUILDER-READY

## Freestanding Bathtubs

Today's smaller bathrooms and construction budgets no longer mean sacrificing the quality or the style of the finished product. Our sleek MAAX freestanding bathtubs have innovative features that make installation easy and affordable no matter how tight your deadline, budget or room.



### 1 tub: 2 pieces

Turns large tub into two smaller, lighter pieces to make moving through doors and along stairs easier.

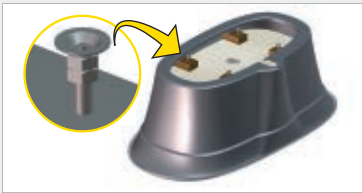

### 4 Leveling Legs

Each leg slides down to the floor and locks securely into place to keep your tub leveled.



### Faucet Installation

The design of MAAX's freestanding bathtubs allows you to install the faucet directly on the deck or fix it to the floor, to your project requirements.

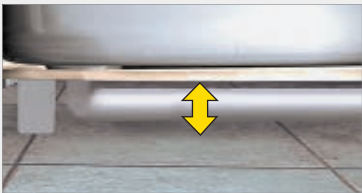

### Above-the-Floor Rough (AFR)

Pipe can be routed without breaking ground or relocating drain. Perfect for installation on concrete slab in renovation or new construction.

## Sax



60" x 32" x 25"

- 2-piece fiberglass bathtub with concealed seam and maximized bathing well
- Deck for faucet • Comfortable high backrest
- 4 leveling legs for ease of installation
- End drain • Above-the-Floor Rough (AFR)
- Apron available in White and 3 bold colors



Aqua



Ruby



Platinum Gray

## Lounge



64" x 34" x 22"

- Rectangular 2-piece acrylic bathtub virtually seamless look
- Deck for faucet • Maximized bathing well
- 4 leveling legs for ease of installation
- End drain • Above-the-Floor Rough (AFR)
- Apron available in White and 3 bold colors



Aqua



Ruby



Platinum Gray

## Serenade



67" x 37" x 24"

- Acrylic bathtub
- Asymmetric modern look
- Deck for faucet
- Center drain • Above-the-Floor Rough (AFR)
- One-piece apron • Available in White only
- Drop-in installation also available





# 2-Piece Freestanding Bathtubs

## Easy Installation Steps

1

### Prepare the site for the installation:

- Ensure floor is level
- Mark the position of the drainage pipe on the floor and make the cut-out using the template provided with the bathtub.

2

Unbolt and remove the apron. Keep all screws and washers.

3

### Level the bathtub using the 4 adjustable legs:

If there is no access from underneath the bathtub:

To facilitate steps 3 & 4, place the bathtub, without the apron, in the designated area to ensure proper fit of the drain and overflow and perfect levelling. Once all validated, remove the bathtub.

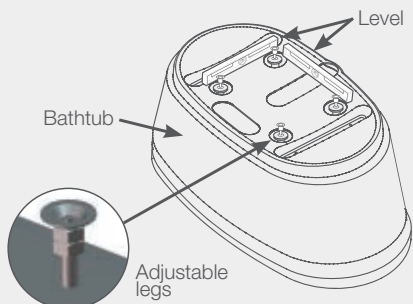

4

Connect the drain and overflow to the floor drain.

5

Apply a silicone seal under the apron (optional).

6

Place the apron on the designated area.

7

Use supplied screws and washers to secure the apron to the floor.

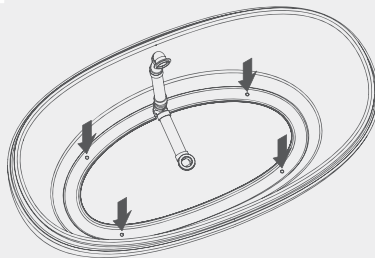

8

Install the deck mounted faucet (if applicable).

9

### Position the bathtub inside the apron:

For deck mounted faucet installation:

To keep the bathtub elevated, insert two 2 x 4's under the deck, across the apron. This will make the faucet connectors available without having to hold the bathtub.

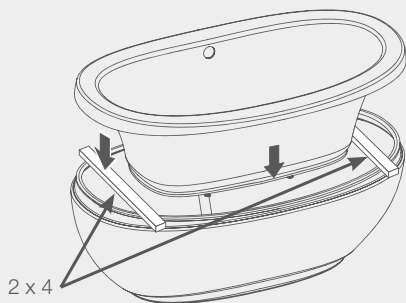

10

### Connect faucet (if deck mounted):

Faucet elements must be attached to a 25" (635 mm) length of flexible ½" hose so bathtub may be lifted when needed.

11

Finalize the drain and overflow connection.

### Suggested tools

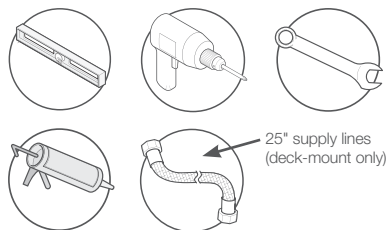

## Servicing

- I. Unscrew the overflow and drain.
- II. Lift the bathtub carefully to avoid pulling a water supply connector further than permitted.
- III. **Insert two 2 x 4's under the deck and across the apron to elevate the bathtub (see step 9).**
- IV. Replace required pieces.
- V. Remove the two 2 x 4's and insert bathtub in apron.
- VI. Finalize drain and overflow connections.

Consult **MAAX Video Gallery** for more details on our 2-piece freestanding bathtub unique features.

**www.maax.com**



# MAAX<sup>®</sup>

Enjoy the experience

For any questions or comments, please contact [info@maax.com](mailto:info@maax.com)

**1-877-GET-MAAX**  
(1-877-438-6229)



[www.maax.com](http://www.maax.com)

EXPERIENCE A GREENER **MAAX<sup>®</sup>**



Sources Mixtes

[www.fsc.org](http://www.fsc.org) Cert no. XXX-XXX-XXXX  
© 1996 Forest Stewardship Council